



IMPORTANT NOTES

- ONLY VISIBLE SERVICES HAVE BEEN LOCATED BY SURVEY.
- NOT ALL SERVICE INFORMATION MAY BE SHOWN DUE TO UNAVAILABILITY OF SERVICE PLANS OR CURRENT INFORMATION.
- INDEPENDENT ENQUIRIES FOR UP-TO-DATE SERVICE LOCATIONS THROUGH THE RELEVANT AUTHORITIES MUST BE UNDERTAKEN PRIOR TO COMMENCEMENT OF ANY WORKS/EXCAVATION. EXACT SERVICE POSITIONS SHOULD BE ESTABLISHED BY APPROPRIATE MEANS. WE RECOMMEND PROFESSIONAL SERVICE LOCATORS.
- THE BOUNDARIES SHOWN ON THIS PLAN ARE BASED ON OUR FIELD SURVEY. TO FORMALISE THESE DIMENSIONS, WE WOULD RECOMMEND THE PREPARATION OF A REDEFINITION PLAN, SUITABLE FOR LODGEMENT AND REGISTRATION WITH NSW LAND REGISTRY SERVICES.
- THIS PLAN SHOULD NOT BE USED FOR BUILDING WORKS CLOSE TO OR ON THE BOUNDARY, OR TO PROSCRIBED SET-BACKS WITHOUT FURTHER SURVEY INVESTIGATION.
- CRITICAL LEVELS (E.G. FLOOR LEVELS) AND CRITICAL LOCATIONS (E.G. STRUCTURES) THAT HAVE NOT BEEN SHOWN MUST BE VERIFIED BY FURTHER SURVEY PRIOR TO FINAL DESIGN.
- NO EXCAVATIONS HAVE BEEN MADE TO DETERMINE THE EXTENT TO WHICH ANY SUBJECT WALLS, FOUNDATIONS OR FOOTINGS MAY ENCROACH UPON ADJOINING LAND.
- NO EXCAVATIONS HAVE BEEN MADE TO DETERMINE THE EXTENT TO WHICH ANY ADJOINING WALLS, FOUNDATIONS OR FOOTINGS MAY ENCROACH UPON SUBJECT LAND.
- ALL TREE DIMENSIONS, HEIGHT (H), CANOPY (C) AND TRUNK DIAMETER (D) HAVE BEEN ESTIMATED. IF ACCURATE DIMENSIONS ARE REQUIRED FOR DESIGN PURPOSES, FURTHER SURVEY SHOULD BE REQUESTED.
- CONTOURS SHOWN DEPICT THE TOPOGRAPHY. CONTOURS DO NOT REPRESENT THE EXACT LEVEL AT ANY PARTICULAR POINT, EXCEPT AT SPOT LEVELS SHOWN.
- THIS PLAN MUST REMAIN UNALTERED AS ISSUED BY MONTEATH & POWYS. ALTERING ANY PART OF THIS PLAN DESTROYS THE INTEGRITY OF THE PLAN. ANY REVISIONS REQUESTED MUST BE ISSUED BY MONTEATH & POWYS.
- THESE NOTES ARE AN INTEGRAL PART OF THIS PLAN. REPRODUCTION OF THIS PLAN OR OF ANY PART OF THIS PLAN, WITHOUT THESE NOTES BEING INCLUDED IN FULL, WILL RENDER THE INFORMATION SHOWN ON SUCH REPRODUCTION INVALID AND NOT SUITABLE FOR USE.

SURVEY INFORMATION

- THE SURVEY IS ON GROUND CO-ORDINATES.
 - THE ORIGIN OF CO-ORDINATES IS PM 44231
 - MGA CO-ORDINATES
 - E 297761.278 N 6243095.162
 - (GDA 2020) (ZONE 56)
 - SOURCE OF CO-ORDINATES: SCIMS
 - DATE 07/07/2022
- ALL REDUCED LEVELS ARE ON AUSTRALIAN HEIGHT DATUM (A.H.D.)
 - ORIGIN OF LEVELS PM 44231, RL81.594
 - SOURCE OF REDUCED LEVELS: SCIMS
 - DATE OF REDUCED LEVELS 07/07/2022
- CONTOUR INTERVAL IS 0.2m.
- MGA AND ISG CO-ORDINATE SYSTEMS ARE BASED ON A MATHEMATICAL EARTH MODEL AND SUBJECT TO VARIABLE SCALE FACTORS. DISTANCES CALCULATED FROM CO-ORDINATES MAY VARY SIGNIFICANTLY FROM GROUND MEASUREMENTS. IF FURTHER CLARIFICATION IS REQUIRED CONTACT MONTEATH AND POWYS.

LEGEND

- DRAINAGE**
- DIP DRAINAGE INLET PIT
 - INV INVERT LEVEL
 - KIP KERB INLET PIT
- ELECTRICITY**
- EPI ELECTRICITY PILLAR
 - EPT ELECTRICITY PIT
 - PP POWER POLE
- MISCELLANEOUS**
- MPIPE MISCELLANEOUS PIPE
 - MPIP MISCELLANEOUS PIT
 - UTL UNABLE TO LIFT
- SEWER**
- SMH SEWER MANHOLE
 - IPS SEWER INSPECTION POINT
 - SVT SEWER VENT
- STRUCTURE**
- SGN SIGN POST
- TELECOMMUNICATIONS**
- TPT TELECOMMUNICATIONS PIT
- TREES**
- TR TREE
 - H HEIGHT OF TREE
 - C SPREAD OF CANOPY
 - D DIAMETER OF TRUNK
- WATER**
- HYD HYDRANT
 - TAP WATER TAP
 - WMT WATER METER

LINE TYPES

- DENOTES FENCING
- DENOTES RETAINING WALL
- DENOTES EDGE OF CONCRETE
- DENOTES TOP OF BANK
- DENOTES TOE OF BANK
- DENOTES EDGE OF BITUMEN
- DENOTES EDGE OF GRAVEL
- DENOTES EDGE OF TREE LINE

SERVICES LINE TYPES

- DRAINAGE LINE CLASS B
- DRAINAGE LINE CLASS C
- DRAINAGE LINE CLASS D
- UNDERGROUND ELECTRICAL CABLE CLASS B
- OVERHEAD ELECTRICITY CABLE
- UNDERGROUND TELECOMMUNICATIONS CABLE CLASS B
- TELECOMMUNICATIONS CABLE (BYDA)
- FIBRE OPTIC CABLE CLASS B
- FIBRE OPTIC CABLE CLASS C
- GAS MAIN CLASS B
- GAS MAIN CLASS C
- SEWER MAIN CLASS B
- SEWER MAIN CLASS C
- WATER MAIN CLASS B
- WATER MAIN CLASS C
- WATER MAIN - FIRE SERVICE CLASS B
- WATER MAIN (BYDA)

SERVICES INFORMATION

SUBSURFACE UTILITY INFORMATION (SU) AS5488. CLASS LABELLING OF UTILITY INFORMATION IS BASED ON A CLASSIFICATION CODE WHICH ALLOWS THE USER OF THIS INFORMATION TO UNDERSTAND CLEARLY HOW THE INFORMATION WAS COLLECTED AND THEN PLACE AN APPROPRIATE AMOUNT OF RELIANCE ON IT. PROJECT RISKS RELATED TO UNDERGROUND UTILITIES CAN THEN BE PROPERLY MANAGED.

- QL-A: INFORMATION IS THE HIGHEST POSSIBLE LEVEL OF ACCURACY AND IS OBTAINED BY EXPOSING THE UNDERGROUND UTILITY USING A NON-DESTRUCTIVE EXCAVATION (POT HOLING) TECHNIQUE. THE VERTICAL INFORMATION FOR THIS LOCATING METHOD IS TO THE TOP OR SHALLOWEST PART OF THE LOCATED SERVICE. THE 3D LOCATION IS RECORDED BY SURVEY AS AN X, Y, Z COORDINATE.
- QL-B: INFORMATION IS COLLECTED BY DESIGNATING THE HORIZONTAL AND VERTICAL LOCATION OF UNDERGROUND UTILITIES BY USING ELECTROMAGNETIC PIPE AND CABLE LOCATORS, SONDES OR FLEXI-TRACE, GROUND PENETRATING RADAR AND ACOUSTIC PULSE EQUIPMENT. THIS IS THE MOST COMMON FORM OF UTILITY LOCATING AND ALTHOUGH AN X, Y AND Z AXIS CAN BE ESTABLISHED IT IS NOT ALWAYS ENTIRELY ACCURATE DUE TO DIFFERING ELECTROMAGNETIC FIELDS, SOIL CONDITIONS AND MULTIPLE BANKS OF CABLES AFFECTING THE LOCATING SIGNAL.
- QL-C: INFORMATION IS COLLECTED BY CORRELATING THE SURVEY OF VISIBLE UTILITY SURFACE FEATURES SUCH AS MARKER PLATES OR WATER HYDRANTS AND ACQUIRED DIAL-BEFORE-YOU-DIG PLANS TO DRAW A STRING WHICH SHOWS THE APPROXIMATE POSITION OF SERVICES. THIS METHOD DOES NOT USUALLY SHOW MULTIPLE BANKS OF CABLES AND DOES NOT ALWAYS SHOW THREE DIMENSIONAL INFORMATION. ELECTRONICALLY TRACED LOCATE MARKS WITH POOR SCRATCHY SIGNALS ARE REPRESENTED AS QL-C.
- QL-D: INFORMATION IS THE MOST BASIC LEVEL OF UTILITY LOCATIONS USING ONLY INFORMATION BASED ON EXISTING DIAL-BEFORE-YOU-DIG PLANS AND BY MEASURING BOUNDARY OFFSETS ETC. THIS METHOD OF UTILITY LOCATIONS SHOULD ALWAYS BE TREATED AS AN INDICATION OF THE PRESENCE OF A SERVICE ONLY AND SHOULD NOT BE USED FOR DESIGN. GPR SCANS ARE ALSO REPRESENTED AS QL-D AS THE GPR IMAGE CANNOT BE CONFIRMED TO IT'S ORIGIN POINT. DEPTHS ON GPR SCAN MUST BE TREATED AS INDICATIVE ONLY.

IMPORTANT SERVICE NOTES

- THE POSITION OF SERVICES LOCATED BY ACCREDITED SERVICES CONTRACTOR USING CONDUCTIVE TRACING TECHNIQUES ARE RECORDED ON THIS PLAN. MONTEATH & POWYS ARE UNABLE TO VERIFY THE ACCURACY OF THESE LOCATIONS AND ADVISE THE REQUIREMENT FOR POSITIVE IDENTIFICATION PRIOR TO EXCAVATION OR CONSTRUCTION IN THEIR VICINITY. ANY DEPTHS OF SERVICES FROM INDUCTIVE TRACING WHICH ARE INDICATED ON THIS PLAN ARE INDICATIVE ONLY AND SHOULD BE VERIFIED BY POT HOLLING IF CRITICAL TO DESIGN.
- NOT ALL SERVICE INFORMATION MAY BE SHOWN DUE TO UNAVAILABILITY OF SERVICE PLANS OR CURRENT INFORMATION.
- THE SERVICES SHOWN IN THIS PLAN HAVE POINT CROSSES WITH ATTRIBUTES. THE ATTRIBUTES CONTAIN INFORMATION RELATED TO THE SERVICE BEING LOCATED. IF USING AUTOCAD, THESE ATTRIBUTES CAN BE TURNED ON OR OFF USING THE ATTDISP COMMAND. ALSO CLICKING ON THE POINT CROSS AND VIEWING THE PROPERTIES OF THAT POINT CROSS WILL LIST THE ATTRIBUTES.
- THIS PLAN MUST REMAIN UNALTERED AS ISSUED BY MONTEATH AND POWYS. ALTERING ANY PART OF THIS PLAN DESTROYS THE INTEGRITY OF THE PLAN. ANY REVISIONS REQUESTED MUST BE ISSUED BY MONTEATH AND POWYS.
- THESE NOTES ARE AN INTEGRAL PART OF THIS PLAN. REPRODUCTION OF THIS PLAN OR OF ANY PART OF THIS PLAN, WITHOUT THESE NOTES BEING INCLUDED IN FULL, WILL RENDER THE INFORMATION SHOWN ON SUCH REPRODUCTION INVALID AND NOT SUITABLE FOR USE.

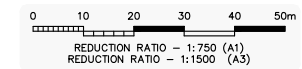

REVISIONS	No	REVISION	SVY	DFT	CHK	DATE
8	EXTRA TREES ADDED TO SHEETS 4, 6 & 7	M&P	MAK	BJB		24/05/24
7	TREE No.52 ADDED TO SHEET 4	JES	MAK	BJB		08/05/24
6	ADDITIONAL ARBORIST TREES	JES	MAK	BJB		02/05/24
5	DEMOUNTABLE BUILDINGS ADDED TO PLAN	M&P	MAK	TR		04/03/24
4	BOUNDARY COORDINATE UPDATED	M&P	MAK	BJB		16/11/23
No	REVISION					

COPYRIGHT NOTICE
THIS DOCUMENT REMAINS THE PROPERTY OF MONTEATH & POWYS PTY LTD. ©

CONDITIONS OF USE.
THIS DOCUMENT MAY ONLY BE USED BY THE CLIENT FOR THE PURPOSE FOR WHICH IT WAS COMMISSIONED. USE OF THE DOCUMENT FOR ANY OTHER PURPOSE IS NOT PERMITTED UNLESS PRIOR WRITTEN APPROVAL HAS BEEN OBTAINED FROM MONTEATH & POWYS PTY LTD.



PLANNING PROJECT MANAGEMENT SURVEYING 3D SPATIAL

monteathpowys.com.au
P (02) 4926 1388

NEWCASTLE SYDNEY GUNNDAH MUSWELLBROOK

Surveyed	Drafted	Checked	Client
WC	MAK	BJB	
REGISTERED SURVEYOR		Original Size	
@A1 : 1:750		A1	
@A3 : 1:1500		DO NOT SCALE	

SCHOOL INFRASTRUCTURE NSW			Sheet No.
Title			1/7
DETAIL SURVEY OF AUSTRAL PUBLIC SCHOOL - LOT 1 DP 512119, LOT 865 DP 2475, LOT 1 DP 398105, LOT 1 DP 398106, LOTS 1 & 2 DP 509613 EDMONDSON AVENUE, AUSTRAL			Revision
CAD File: 220216C_08			8
Ref No: 22/0216	Date: 07/07/2022		

TENTH

AVENUE

AVENUE

EDMONDSON

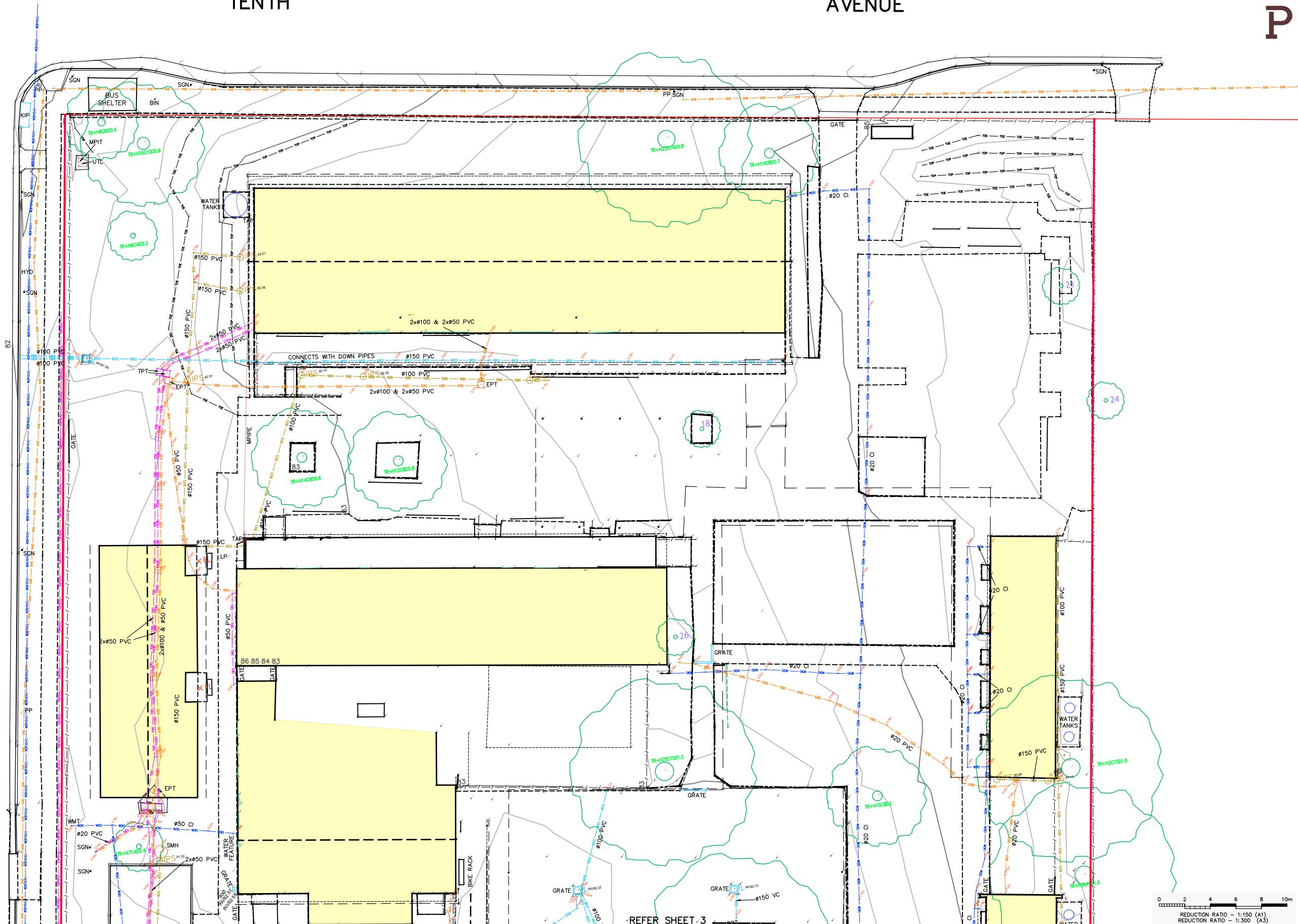

REVISIONS	No	REVISION	SVY	DFT	CHK	DATE
	8	EXTRA TREES ADDED TO SHEETS 4, 6 & 7	M&P	MAK	BJB	24/05/24
	7	TREE No.52 ADDED TO SHEET 4	JES	MAK	BJB	08/05/24
	6	ADDITIONAL ARBORIST TREES	JES	MAK	BJB	02/05/24
	5	DEMOUNTABLE BUILDINGS ADDED TO PLAN	M&P	MAK	TR	04/03/24
	4	BOUNDARY COORDINATE UPDATED	M&P	MAK	BJB	16/11/23
	No	REVISION	SVY	DFT	CHK	DATE

Copyright Notice
 THIS DOCUMENT REMAINS THE PROPERTY OF MONTEATH & POWYS PTY LTD. ©

Conditions of Use
 THIS DOCUMENT MAY ONLY BE USED BY THE CLIENT FOR THE PURPOSE FOR WHICH IT WAS COMMISSIONED. USE OF THE DOCUMENT FOR ANY OTHER PURPOSE IS NOT PERMITTED UNLESS PRIOR WRITTEN APPROVAL HAS BEEN OBTAINED FROM MONTEATH & POWYS PTY LTD.



PLANNING PROJECT MANAGEMENT SURVEYING 3D SPATIAL

monteathpowys.com.au
 P (02) 4926 1388

NEWCASTLE SYDNEY GUNNDAH MUSWELLBROOK

Surveyed	Drafted	Checked	Client
WC	MAK	BJB	
REGISTERED SURVEYOR		Original Size	
@A1 : 1:150			
@A3 : 1:300			
DO NOT SCALE		A1	

SCHOOL INFRASTRUCTURE NSW

Title: DETAIL SURVEY OF AUSTRAL PUBLIC SCHOOL - LOT 1 DP 512119, LOT 865 DP 2475, LOT 1 DP 398105, LOT 1 DP 398106, LOTS 1 & 2 DP 509613 EDMONDSON AVENUE, AUSTRAL

CAD File: 220216C_08 Ref No: 22/0216 Date: 07/07/2022

Sheet No. 2 / 7
 Revision 8

AVENUE

EDMONDSON

MGA

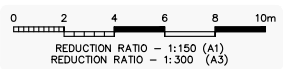
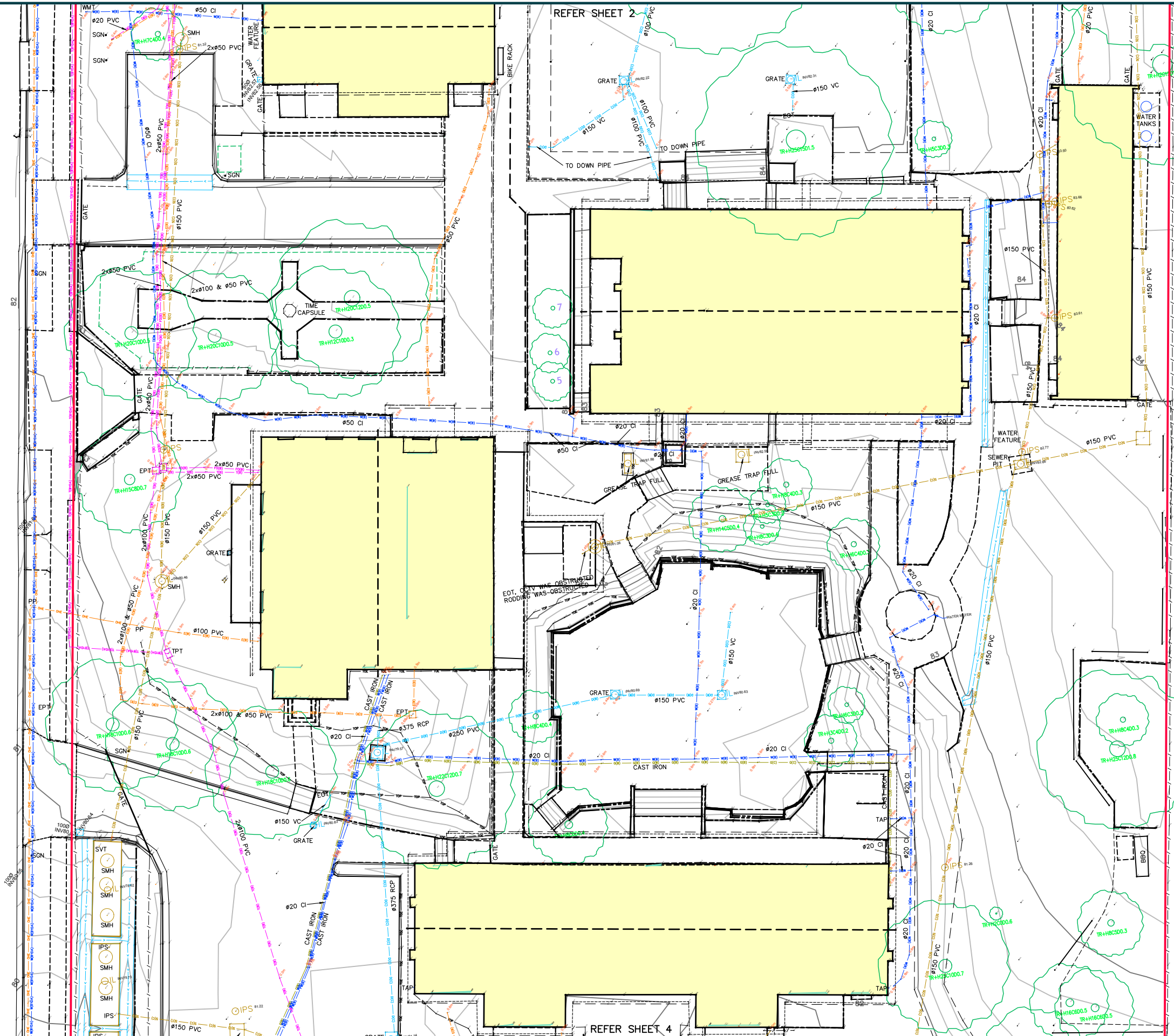

REVISIONS	No	REVISION	SVY	DFT	CHK	DATE
	8	EXTRA TREES ADDED TO SHEETS 4, 6 & 7	M&P	MAK	BJB	24/05/24
	7	TREE No.52 ADDED TO SHEET 4	JES	MAK	BJB	08/05/24
	6	ADDITIONAL ARBORIST TREES	JES	MAK	BJB	02/05/24
	5	DEMOUNTABLE BUILDINGS ADDED TO PLAN	M&P	MAK	TR	04/03/24
	4	BOUNDARY COORDINATE UPDATED	M&P	MAK	BJB	16/11/23
	No	REVISION	SVY	DFT	CHK	DATE

COPYRIGHT NOTICE
THIS DOCUMENT REMAINS THE PROPERTY OF MONTEATH & POWYS PTY LTD. ©

CONDITIONS OF USE.
THIS DOCUMENT MAY ONLY BE USED BY THE CLIENT FOR THE PURPOSE FOR WHICH IT WAS COMMISSIONED. USE OF THE DOCUMENT FOR ANY OTHER PURPOSE IS NOT PERMITTED UNLESS PRIOR WRITTEN APPROVAL HAS BEEN OBTAINED FROM MONTEATH & POWYS PTY LTD.



PLANNING PROJECT MANAGEMENT SURVEYING 3D SPATIAL

monteathpowys.com.au
P (02) 4926 1388

NEWCASTLE SYDNEY GUNNDAH MUSWELLBROOK

Surveyed	Drafted	Checked
WC	MAK	BJB
REGISTERED SURVEYOR		
@A1 : 1:150	Original Size	
@A3 : 1:300	A1	
DO NOT SCALE		

Client
SCHOOL INFRASTRUCTURE NSW

Title
DETAIL SURVEY OF AUSTRAL PUBLIC SCHOOL - LOT 1 DP 512119,
LOT 865 DP 2475, LOT 1 DP 398105, LOT 1 DP 398106, LOTS 1 & 2 DP 509613
EDMONDSON AVENUE, AUSTRAL

CAD File: 220216C_08 Ref No: 22/0216 Date: 07/07/2022

Sheet No.
3 / 7

Revision
8

AVENUE

EDMONDSON

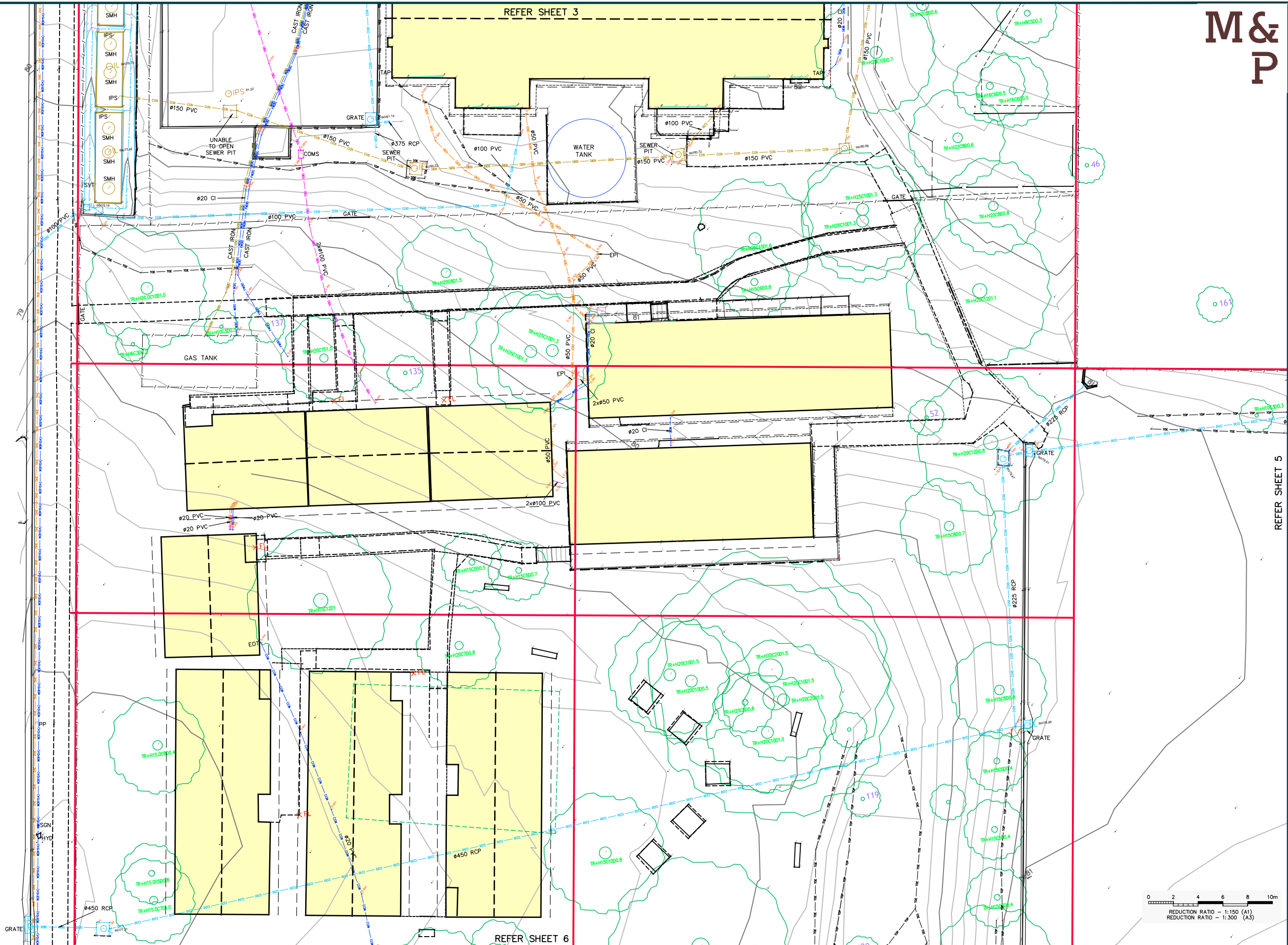

0 2 4 6 8 10m
 REDUCTION RATIO - 1:150 (A1)
 REDUCTION RATIO - 1:300 (A3)

REVISIONS	No	REVISION	SVY	DFT	CHK	DATE
	8	EXTRA TREES ADDED TO SHEETS 4, 6 & 7	M&P	MAK	BJB	24/05/24
	7	TREE No.52 ADDED TO SHEET 4	JES	MAK	BJB	08/05/24
	6	ADDITIONAL ARBORIST TREES	JES	MAK	BJB	02/05/24
	5	DEMOUNTABLE BUILDINGS ADDED TO PLAN	M&P	MAK	TR	04/03/24
	4	BOUNDARY COORDINATE UPDATED	M&P	MAK	BJB	16/11/23
	No	REVISION	SVY	DFT	CHK	DATE

COPYRIGHT NOTICE
 THIS DOCUMENT REMAINS THE PROPERTY OF MONTEATH & POWYS PTY LTD. ©

CONDITIONS OF USE.
 THIS DOCUMENT MAY ONLY BE USED BY THE CLIENT FOR THE PURPOSE FOR WHICH IT WAS COMMISSIONED. USE OF THE DOCUMENT FOR ANY OTHER PURPOSE IS NOT PERMITTED UNLESS PRIOR WRITTEN APPROVAL HAS BEEN OBTAINED FROM MONTEATH & POWYS PTY LTD.



PLANNING PROJECT MANAGEMENT SURVEYING 3D SPATIAL
 monteathpowys.com.au
 P (02) 4926 1388
 NEWCASTLE SYDNEY GUNNDAH MUSWELLBROOK

Surveyed	Drafted	Checked	Client
WC	MAK	BJB	
REGISTERED SURVEYOR		Original Size	
@A1 : 1:150		A1	
@A3 : 1:300		DO NOT SCALE	

SCHOOL INFRASTRUCTURE NSW

Title: **DETAIL SURVEY OF AUSTRAL PUBLIC SCHOOL - LOT 1 DP 512119, LOT 865 DP 2475, LOT 1 DP 398105, LOT 1 DP 398106, LOTS 1 & 2 DP 509613 EDMONDSON AVENUE, AUSTRAL**

CAD File: 220216C_08 Ref No: 22/0216 Date: 07/07/2022

Sheet No.
4 / 7
 Revision
8

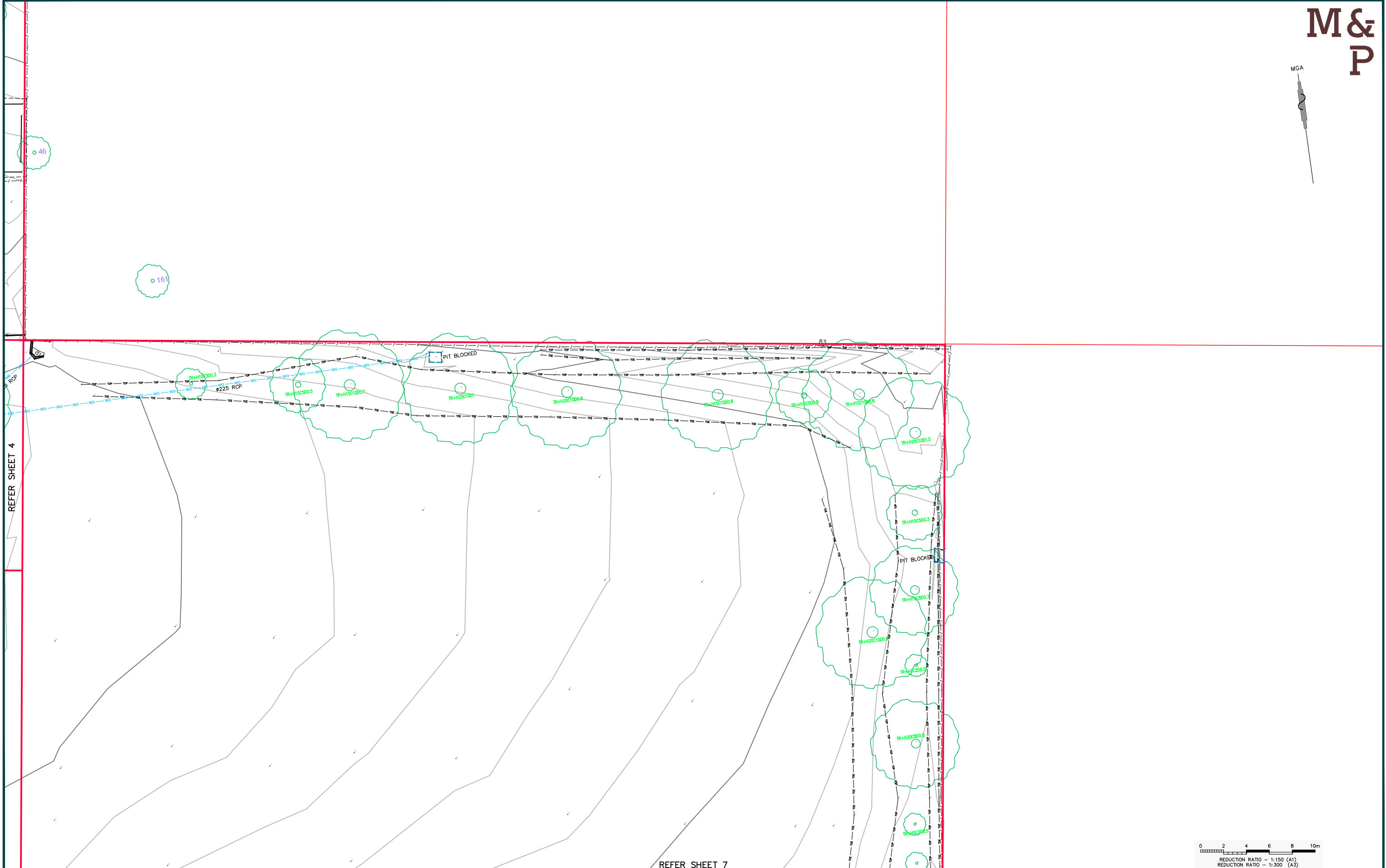

REFER SHEET 4

REFER SHEET 7

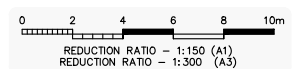

REVISIONS	No	REVISION	SVY	DFT	CHK	DATE
	8	EXTRA TREES ADDED TO SHEETS 4, 6 & 7	M&P	MAK	BJB	24/05/24
	7	TREE No.52 ADDED TO SHEET 4	JES	MAK	BJB	08/05/24
	6	ADDITIONAL ARBORIST TREES	JES	MAK	BJB	02/05/24
	5	DEMOUNTABLE BUILDINGS ADDED TO PLAN	M&P	MAK	TR	04/03/24
	4	BOUNDARY COORDINATE UPDATED	M&P	MAK	BJB	16/11/23

COPYRIGHT NOTICE
THIS DOCUMENT REMAINS THE PROPERTY OF MONTEATH & POWYS PTY LTD. ©

CONDITIONS OF USE.
THIS DOCUMENT MAY ONLY BE USED BY THE CLIENT FOR THE PURPOSE FOR WHICH IT WAS COMMISSIONED. USE OF THE DOCUMENT FOR ANY OTHER PURPOSE IS NOT PERMITTED UNLESS PRIOR WRITTEN APPROVAL HAS BEEN OBTAINED FROM MONTEATH & POWYS PTY LTD.



PLANNING PROJECT MANAGEMENT SURVEYING 3D SPATIAL

monteathpowys.com.au
P (02) 4926 1388

NEWCASTLE SYDNEY GUNNDAH MUSWELLBROOK



Surveyed	Drafted	Checked
WC	MAK	BJB
REGISTERED SURVEYOR		
Original Size		
DO NOT SCALE		

Client	SCHOOL INFRASTRUCTURE NSW
Title	DETAIL SURVEY OF AUSTRAL PUBLIC SCHOOL - LOT 1 DP 512119, LOT 865 DP 2475, LOT 1 DP 398105, LOT 1 DP 398106, LOTS 1 & 2 DP 509613 EDMONDSON AVENUE, AUSTRAL
CAD File:	220216C_08
Ref No:	22/0216
Date:	07/07/2022

Sheet No.
5 / 7

Revision
8

EDMONDSON AVENUE

EDMONDSON AVENUE

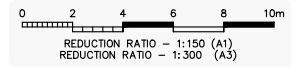
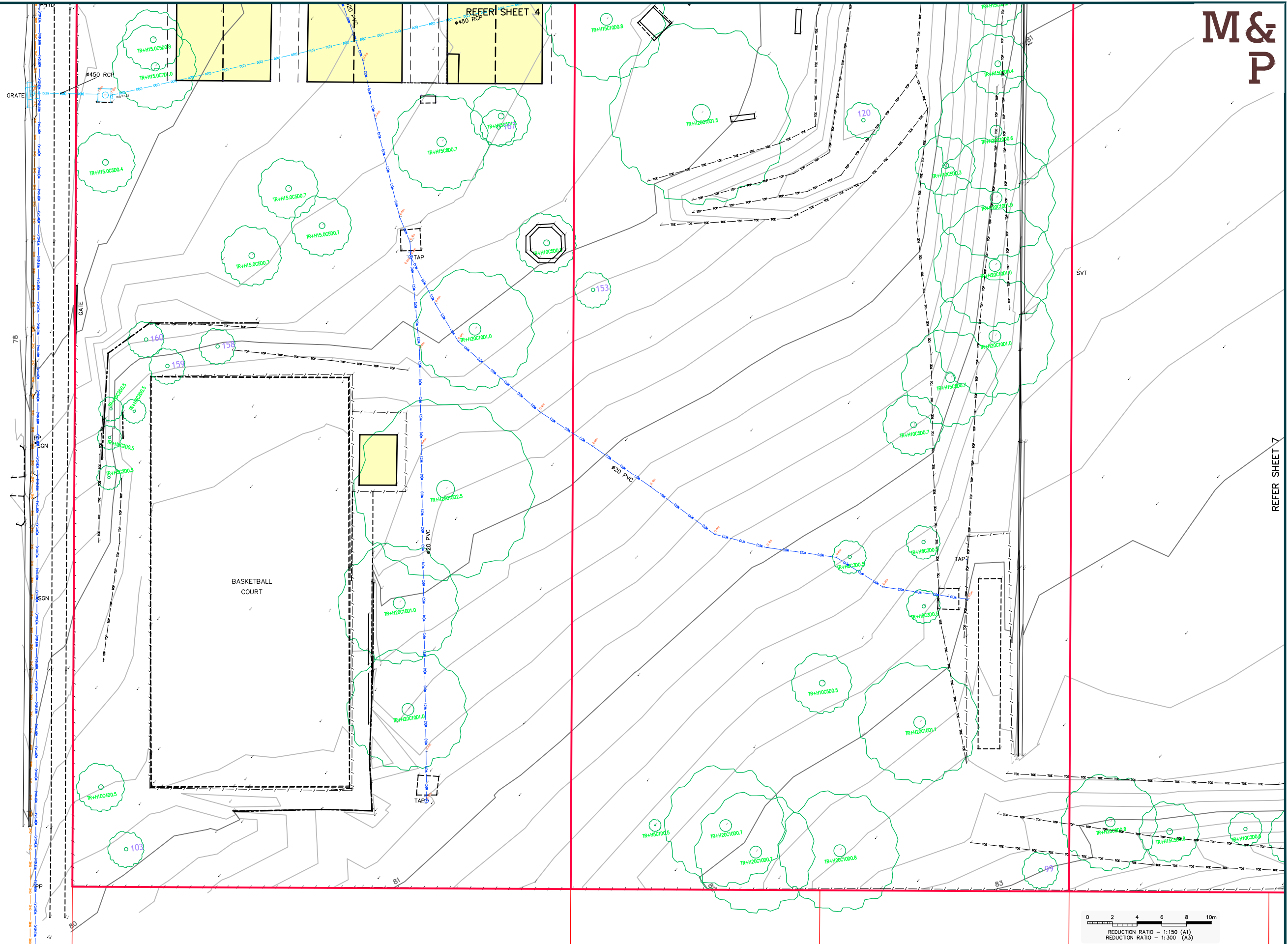

REVISIONS	No	REVISION	SVY	DFT	CHK	DATE
	8	EXTRA TREES ADDED TO SHEETS 4, 6 & 7	M&P	MAK	BJB	24/05/24
	7	TREE No.52 ADDED TO SHEET 4	JES	MAK	BJB	08/05/24
	6	ADDITIONAL ARBORIST TREES	JES	MAK	BJB	02/05/24
	5	DEMOUNTABLE BUILDINGS ADDED TO PLAN	M&P	MAK	TR	04/03/24
	4	BOUNDARY COORDINATE UPDATED	M&P	MAK	BJB	16/11/23
	No	REVISION				

COPYRIGHT NOTICE
THIS DOCUMENT REMAINS THE PROPERTY OF MONTEATH & POWYS PTY LTD. ©

CONDITIONS OF USE.
THIS DOCUMENT MAY ONLY BE USED BY THE CLIENT FOR THE PURPOSE FOR WHICH IT WAS COMMISSIONED. USE OF THE DOCUMENT FOR ANY OTHER PURPOSE IS NOT PERMITTED UNLESS PRIOR WRITTEN APPROVAL HAS BEEN OBTAINED FROM MONTEATH & POWYS PTY LTD.



PLANNING PROJECT MANAGEMENT SURVEYING 3D SPATIAL

monteathpowys.com.au
P (02) 4926 1388

NEWCASTLE SYDNEY GUNNDAH MUSWELLBROOK

Surveyed	Drafted	Checked
WC	MAK	BJB
REGISTERED SURVEYOR		
@A1 : 1:150	Original Size	
@A3 : 1:300	A1	
DO NOT SCALE		

Client	SCHOOL INFRASTRUCTURE NSW	
Title	DETAIL SURVEY OF AUSTRAL PUBLIC SCHOOL - LOT 1 DP 512119, LOT 865 DP 2475, LOT 1 DP 398105, LOT 1 DP 398106, LOTS 1 & 2 DP 509613 EDMONDSON AVENUE, AUSTRAL	
CAD File:	220216C_08	Ref No: 22/0216
Date:	07/07/2022	

Sheet No.
6 / 7

Revision
8

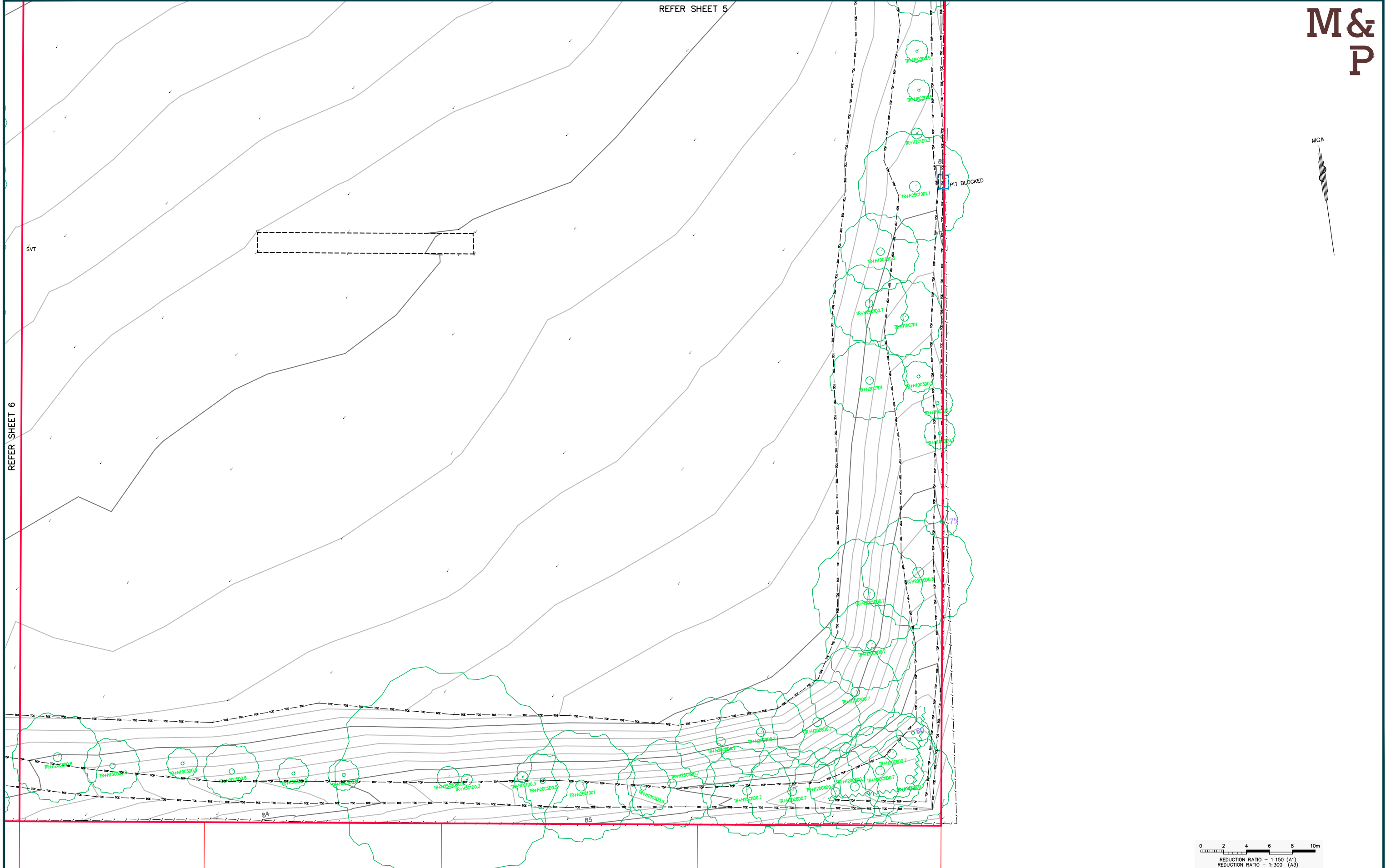

REFER SHEET 6

No	REVISION	SVY	DFT	CHK	DATE
8	EXTRA TREES ADDED TO SHEETS 4, 6 & 7	M&P	MAK	BJB	24/05/24
7	TREE No.52 ADDED TO SHEET 4	JES	MAK	BJB	08/05/24
6	ADDITIONAL ARBORIST TREES	JES	MAK	BJB	02/05/24
5	DEMOUNTABLE BUILDINGS ADDED TO PLAN	M&P	MAK	TR	04/03/24
4	BOUNDARY COORDINATE UPDATED	M&P	MAK	BJB	16/11/23

COPYRIGHT NOTICE
 THIS DOCUMENT REMAINS THE PROPERTY OF MONTEATH & POWYS PTY LTD. ©

CONDITIONS OF USE.
 THIS DOCUMENT MAY ONLY BE USED BY THE CLIENT FOR THE PURPOSE FOR WHICH IT WAS COMMISSIONED. USE OF THE DOCUMENT FOR ANY OTHER PURPOSE IS NOT PERMITTED UNLESS PRIOR WRITTEN APPROVAL HAS BEEN OBTAINED FROM MONTEATH & POWYS PTY LTD.



PLANNING PROJECT MANAGEMENT SURVEYING 3D SPATIAL

monteathpowys.com.au
 P (02) 4926 1388

NEWCASTLE SYDNEY GUNNEDAH MUSWELLBROOK

Surveyed	Drafted	Checked
WC	MAK	BJB
REGISTERED SURVEYOR		
@A1 : 1:150	Original Size	
@A3 : 1:300	A1	
DO NOT SCALE		

Client	SCHOOL INFRASTRUCTURE NSW
Title	DETAIL SURVEY OF AUSTRAL PUBLIC SCHOOL - LOT 1 DP 512119, LOT 865 DP 2475, LOT 1 DP 398105, LOT 1 DP 398106, LOTS 1 & 2 DP 509613 EDMONDSON AVENUE, AUSTRAL
CAD File:	220216C_08
Ref No:	22/0216
Date:	07/07/2022

Sheet No. 7 / 7

Revision 8

